

The information contained in this drawing is the sole property of CWS Coil Winding Specialist. Any reproduction in part or whole without written permission of CWS Coil Winding Specialist is prohibited.

REVISION HISTORY			
REV	ECN	DESCRIPTION	DATE
A		PRODUCTION RELEASE	2/9/04

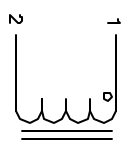

SCHEMATIC

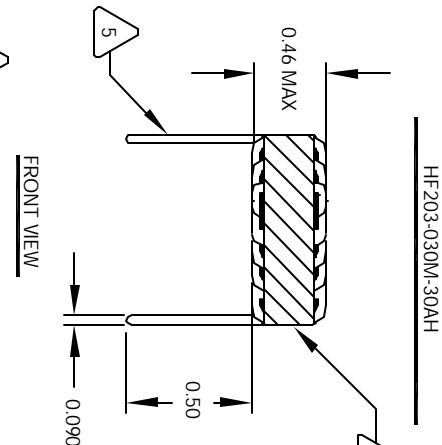

FRONT VIEW

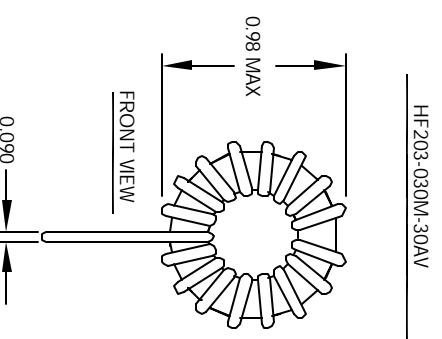

FRONT VIEW

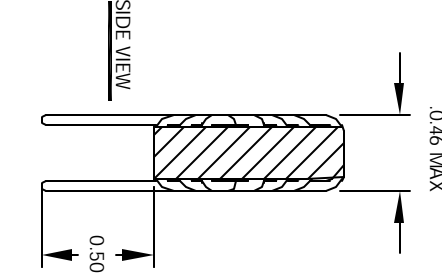

SIDE VIEW

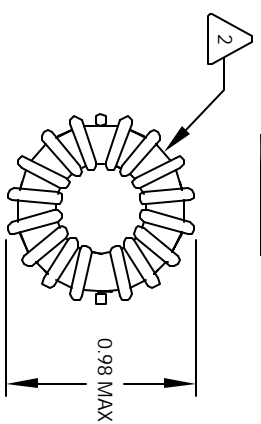

BOTTOM VIEW

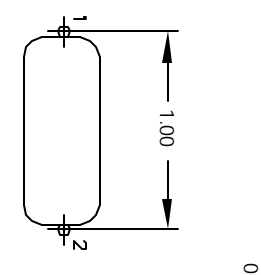

MOUNTING HOLES PATTERN



FRONT VIEW

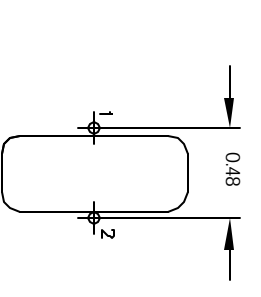

MOUNTING HOLES PATTERN

6 USING A PERMANENT MARKING METHOD MARK PART NUMBER AND REVISION, IF APPLICABLE IF NEEDED, WRAP INDUCTOR WITH GLASS TAPE

5 TO THE CORE MUST REST FLAT ON PCB. LEADS MUST BE TANGENT FLUSH WITH THE COIL EDGE, AS SHOWN (I.E. COIL REMOVE INSULATION AND TIN LEADS 0.50 INCH

4 WIND COILS EVENLY SPACED AROUND THE CORE CONSTRUCTION:

HI-POT TEST FOR WINDING TO CORE ISOLATION = 500VDC MIN
 CURRENT RATING : 30 AMPS, 40 °C TEMP. RISE, NO AIR FLOW
 DCR = 1.0 MILLI-OHMS MAX.
 DC BIASED = 30 AMPS, INDUCTANCE = 3.0 UH
 DC BIASED = 29.1 AMPS, INDUCTANCE = 3.0 UH
 INDUCTANCE = 3.0 UH +/-10% @ LOW DC BIAS, 1 KHZ, 250mV
 3 SPECIFICATIONS:

2 WIRE: UL RECOGNIZED 200°C RATED MAGNET WIRE
 CWS BYTE-MARK OR OTHER APPROVED PART
 CORE: COATED HIGH FLUX TOROIDAL CORE

1 RATING CLASS B (130°C MIN.) REQUIRED
 MATERIAL: UL RECOGNIZED 94V-0 FOR FLAMMABILITY
 NOTES: TOROIDAL POWER CHOKE. ALL DIMENSIONS IN INCHES

CODE IDENT	MFG. P/N	DESCRIPTION	ITEM NO.
PARTS LIST			
AUTOCAD SOLIDWORKS SIGN	X	CWS Coil Winding Specialist. www.cwswire.com	
DATE	DATE	1510 E. Edinger Ave. Unit B, Santa Ana, CA 92705	
DRAWN TKK	2/8/04	TITLE: Toroidal Power Chokes	
CHKD JLAU	2/9/04		
ENGR KSUN	3/6/04		
APPR. JLAU	3/6/04	SIZE: DIM. IN. B	REV B
DO NOT SCALE DRAWING		SCALE: 2=1	SHEET 1 OF 1